

## Offerte aanvraag | Beker Elevatoren

Company \_\_\_\_\_ City \_\_\_\_\_  
 Requested by \_\_\_\_\_ Country \_\_\_\_\_  
 Address \_\_\_\_\_ Phone number \_\_\_\_\_  
 \_\_\_\_\_ Email \_\_\_\_\_  
 Zipcode \_\_\_\_\_

### Select your model

Choose one of the boxes below

Z model

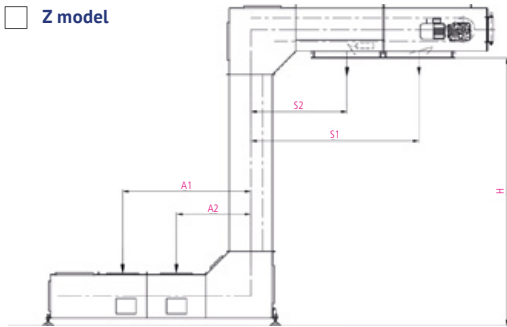

C model

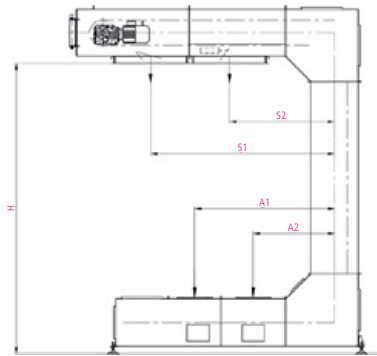

### Product details

Product in bekers \_\_\_\_\_  
 Product afmetingen (mm) \_\_\_\_\_  
 Product temperatuur (°C) \_\_\_\_\_  
 Abrasief  Yes  No  
 Vochtigheid (%) \_\_\_\_\_  
 Transport quantity (kg/h) \_\_\_\_\_  
 Bulk density (kg/tr) \_\_\_\_\_  
 Transport volume (ltr/h) \_\_\_\_\_  
 Number of outlets \_\_\_\_\_  
 Number of inlets \_\_\_\_\_

#### Dimensions (mm)

Configuration  Z  C Other \_\_\_\_\_  
 A1 = \_\_\_\_\_ A2 = \_\_\_\_\_ A3 = \_\_\_\_\_  
 S1 = \_\_\_\_\_ S2 = \_\_\_\_\_ S3 = \_\_\_\_\_  
 S4 = \_\_\_\_\_ S5 = \_\_\_\_\_ S6 = \_\_\_\_\_  
 H = (incl. 100 mm support) \_\_\_\_\_  
 Power supply (V) \_\_\_\_\_ (HZ) \_\_\_\_\_  
 Production hours (h/24h) \_\_\_\_\_ (days/week) \_\_\_\_\_

#### Construction

Waterproof for outside installation  Yes  No

#### Execution

- Carbon steel, any RAL colour  
 Machine with steel body  
 Full stainless steel machine

#### Comments

\_\_\_\_\_